



#11.SEFT.037 Complete sliding door lock, strike and key/thumb-turn

Lever #12.53F

Escutcheon #12.222

All sets include: 1 keyway  with 2 keys and 1 thumb-turn  (optional: 2 keyways, no thumb-turn).

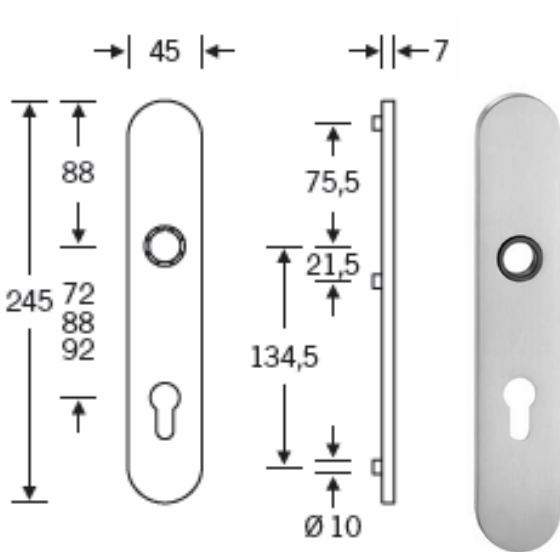

Escutcheon #12.222

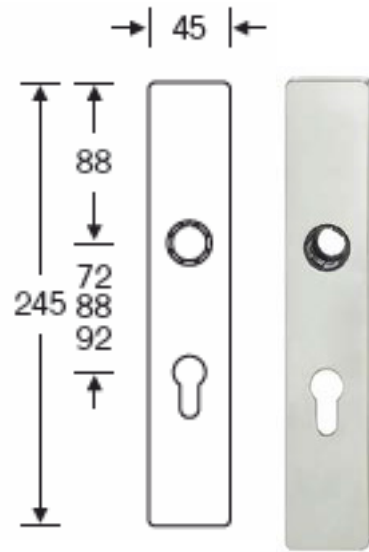

Escutcheon #12.1410

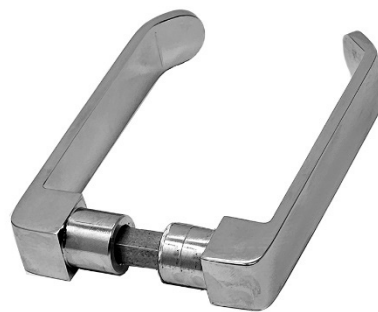

Lever #12.53F.308